

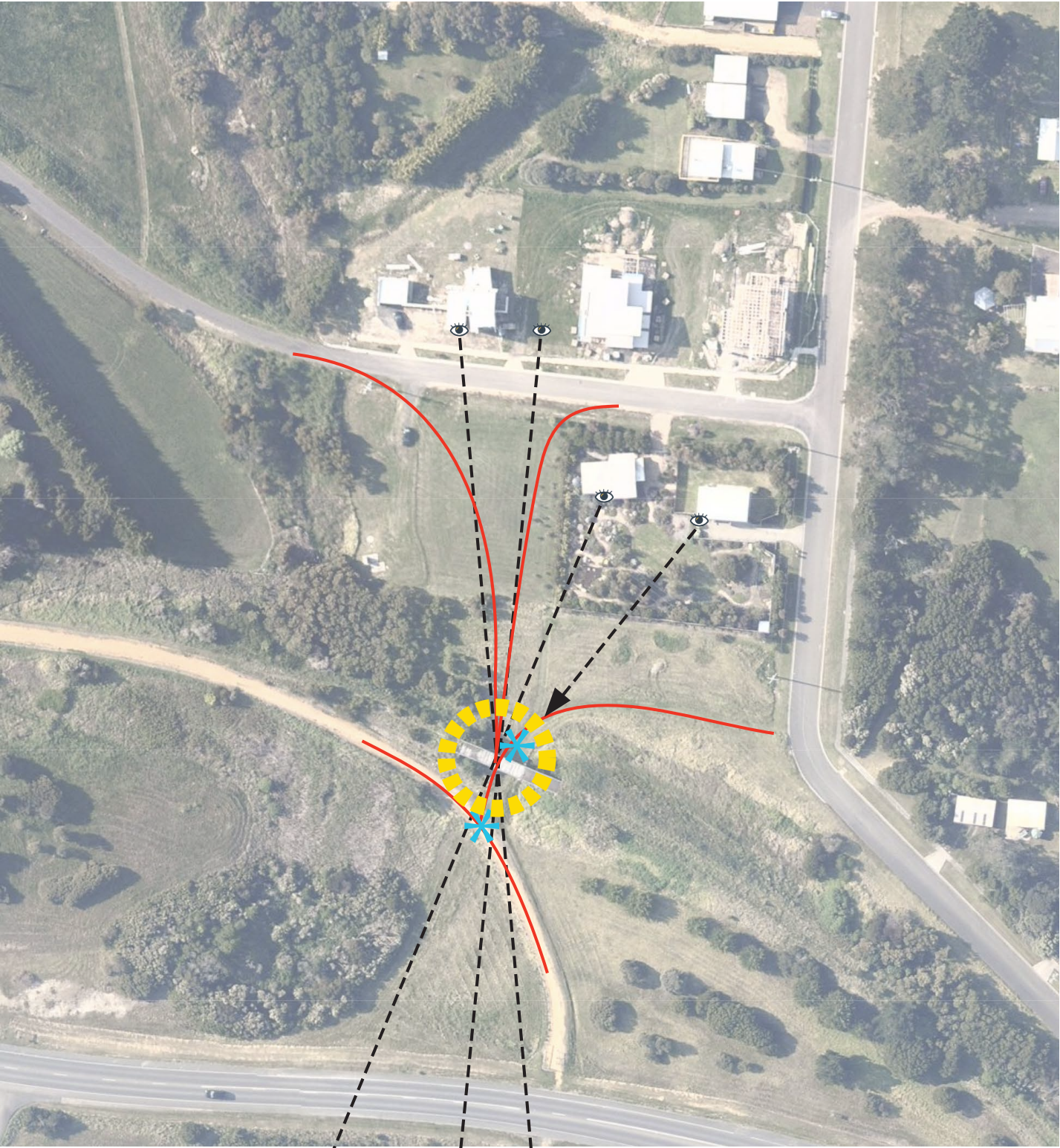

KILCUNDA VIADUCT PORTAL _PRELIMINARY CONCEPT IMAGERY



Legend:

- SUBJECT SITE
- LOCAL SIGHT LINES
- TYPICAL FOOT TRAFFIC
- PEDESTRIAN OBSTACLE

SITE ANALYSIS & NOTES:

1. There are 3 local residences that currently enjoy views of and through the bridge, the proposal should be sensitive to these sight lines

2. The pathway beneath the bridge is often too wet and soggy in the winter months to be used. An elevated path could be considered as part of this proposal to help this issue.

3. To access the rail trail there is an awkward transition due to levels & swale drain, a solution to provide better access could be considered as part of this project.

4. The bridge is being overgrown with weedy shrubs - mainly *Coprosma repens* (Mirror Bush) which are impacting the amenity and likely accelerating degradation of parts of the bridge. These weed should be removed following this project.

Low indigenous planting to the embankment would be beneficial for improved amenity & maintenance.

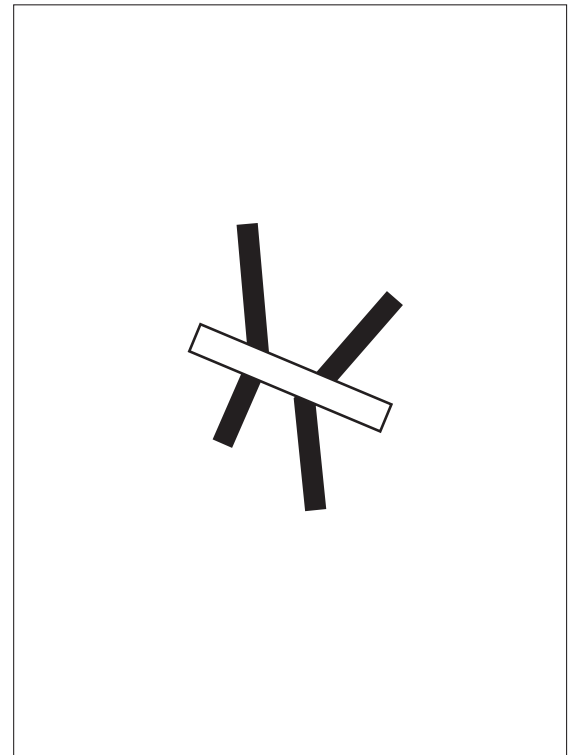
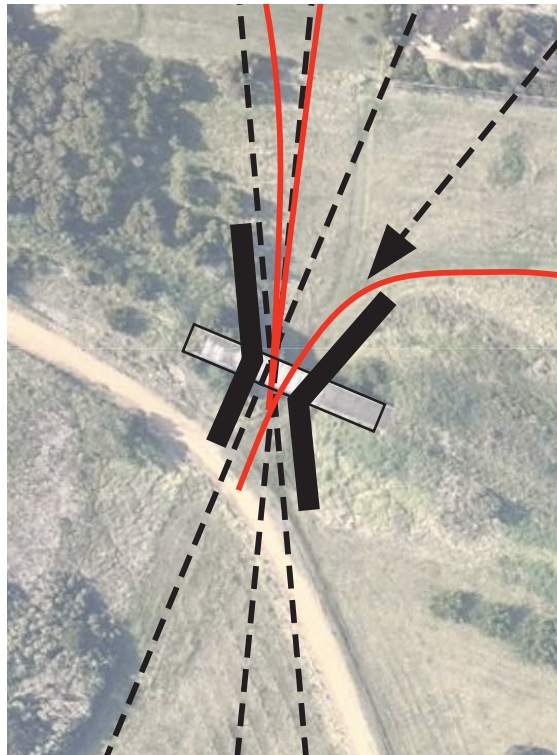

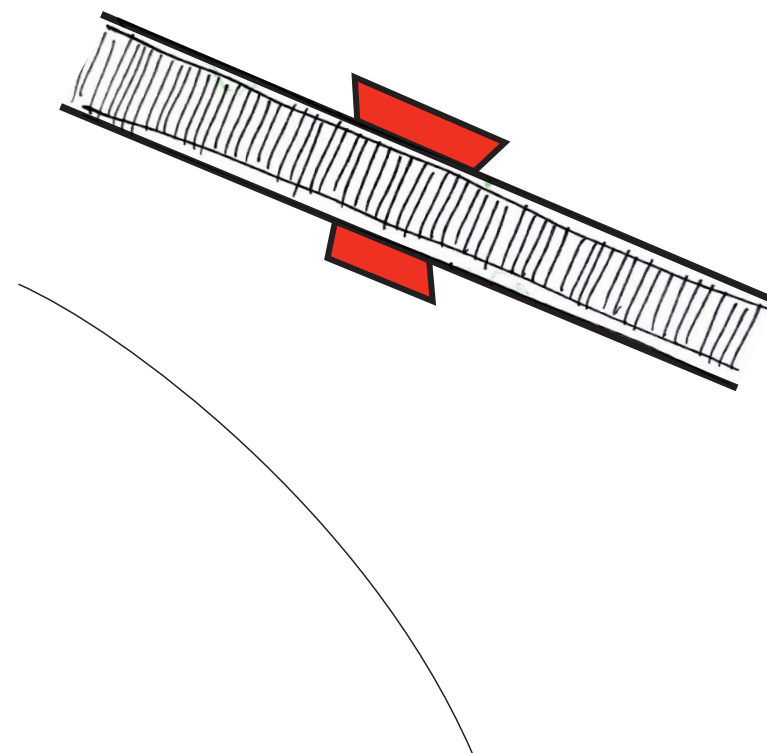
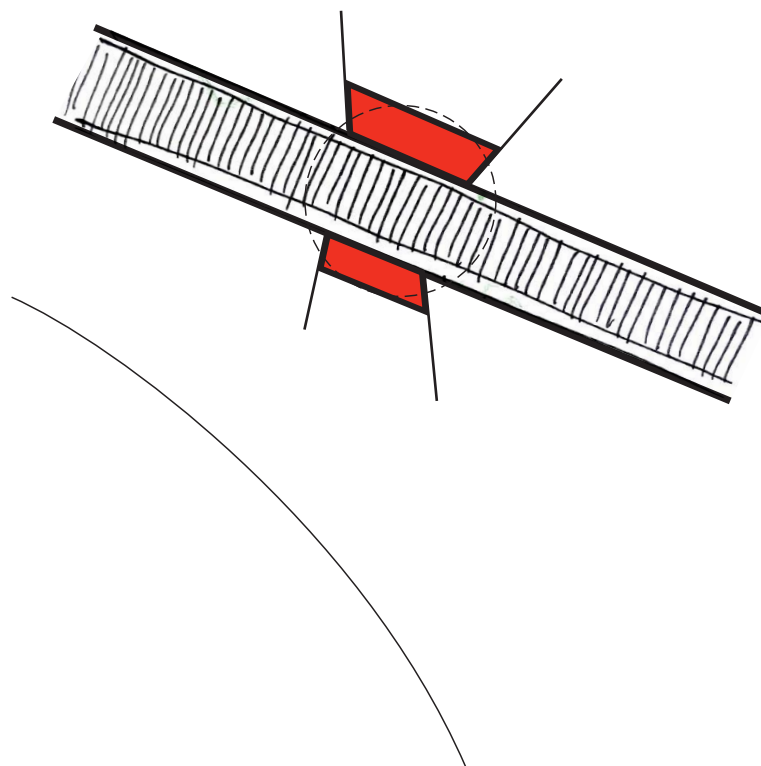
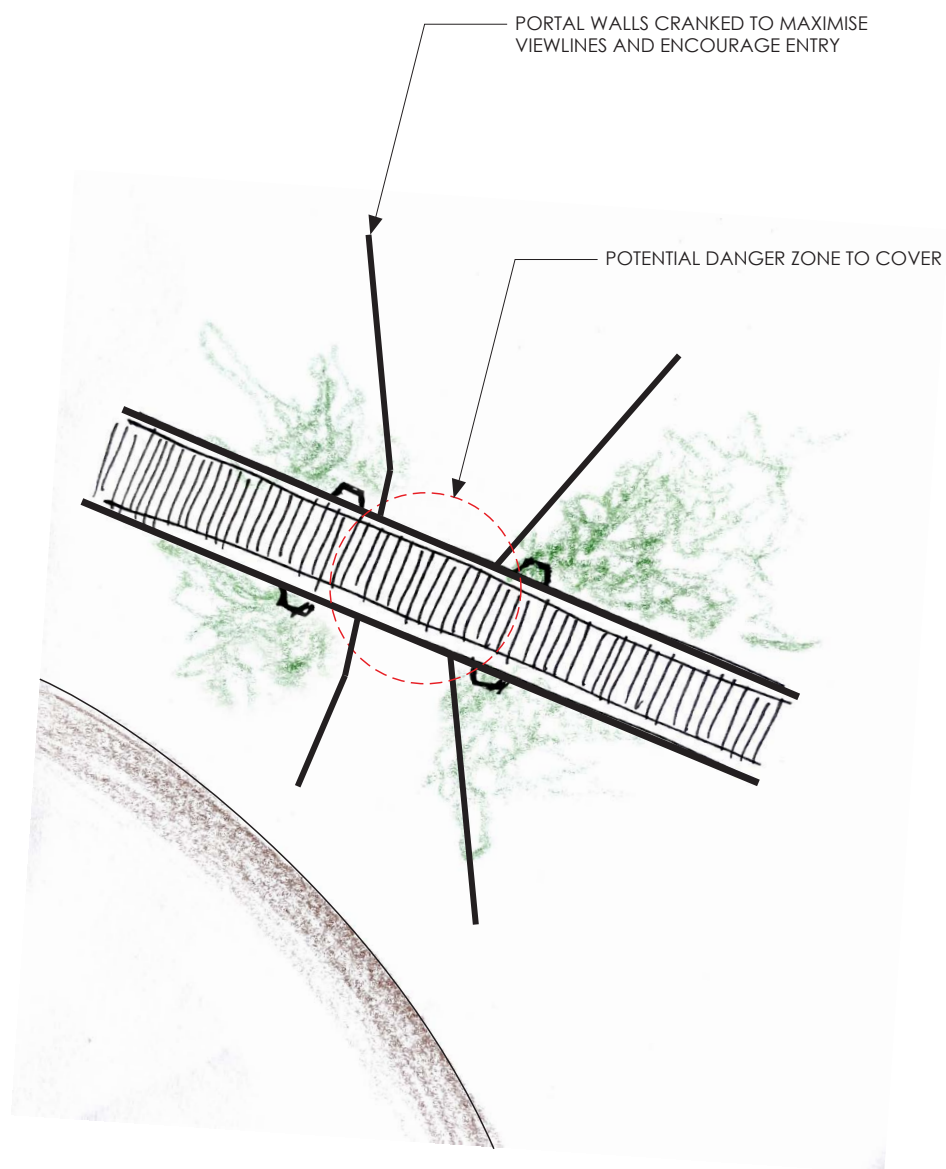

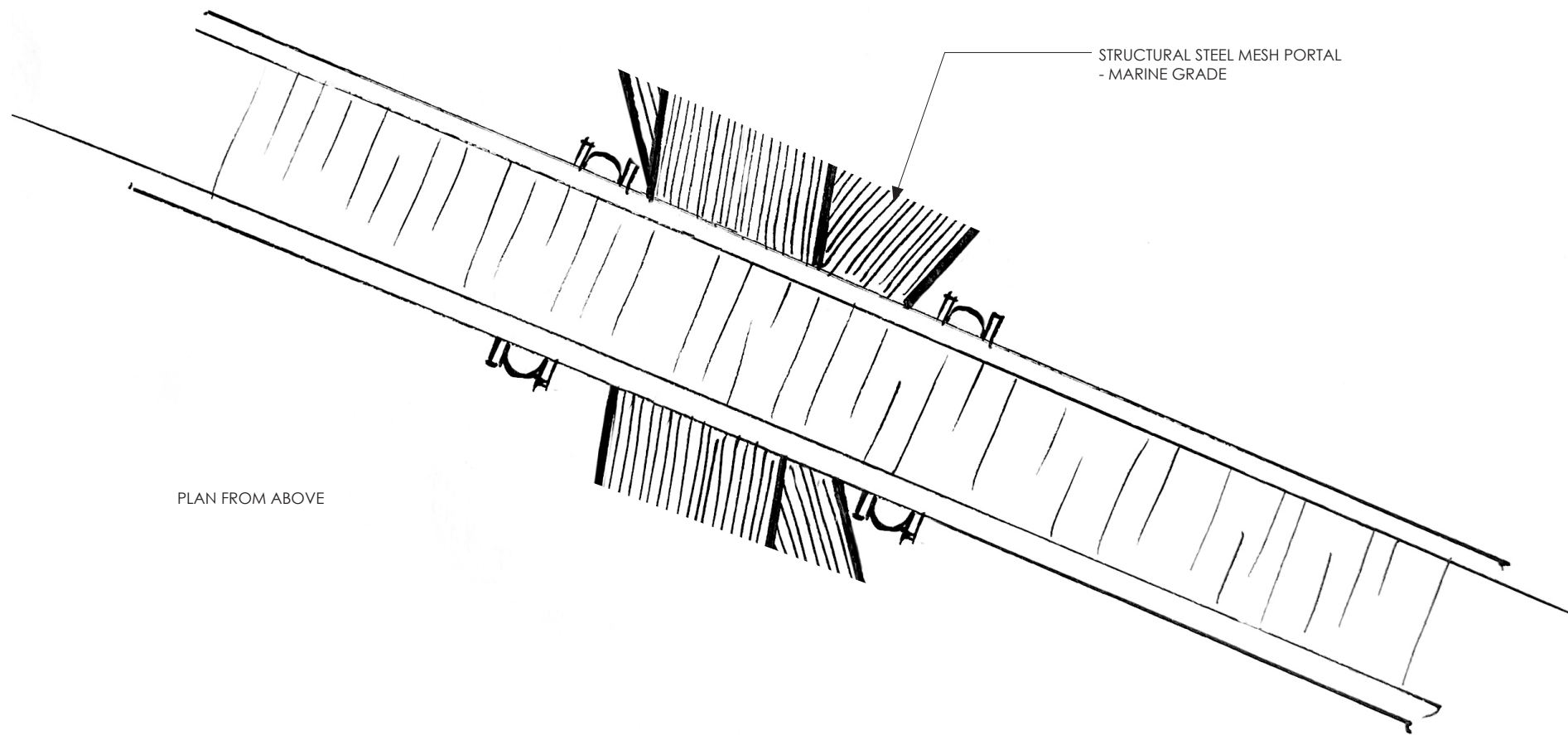

PLAN FROM ABOVE



- MATERIAL NOTES:
- STEEL MESH PORTAL MATERIAL (GRIDFORGE MESH GRATING)
 - STRUCTURAL RIGIDITY & STRENGTH
 - TRANSPARENT & VISUALLY 'LIGHTWEIGHT'
 - HOT-DIP GALVANISED OR STAINLESS STEEL - MARINE GRADE QUALITY

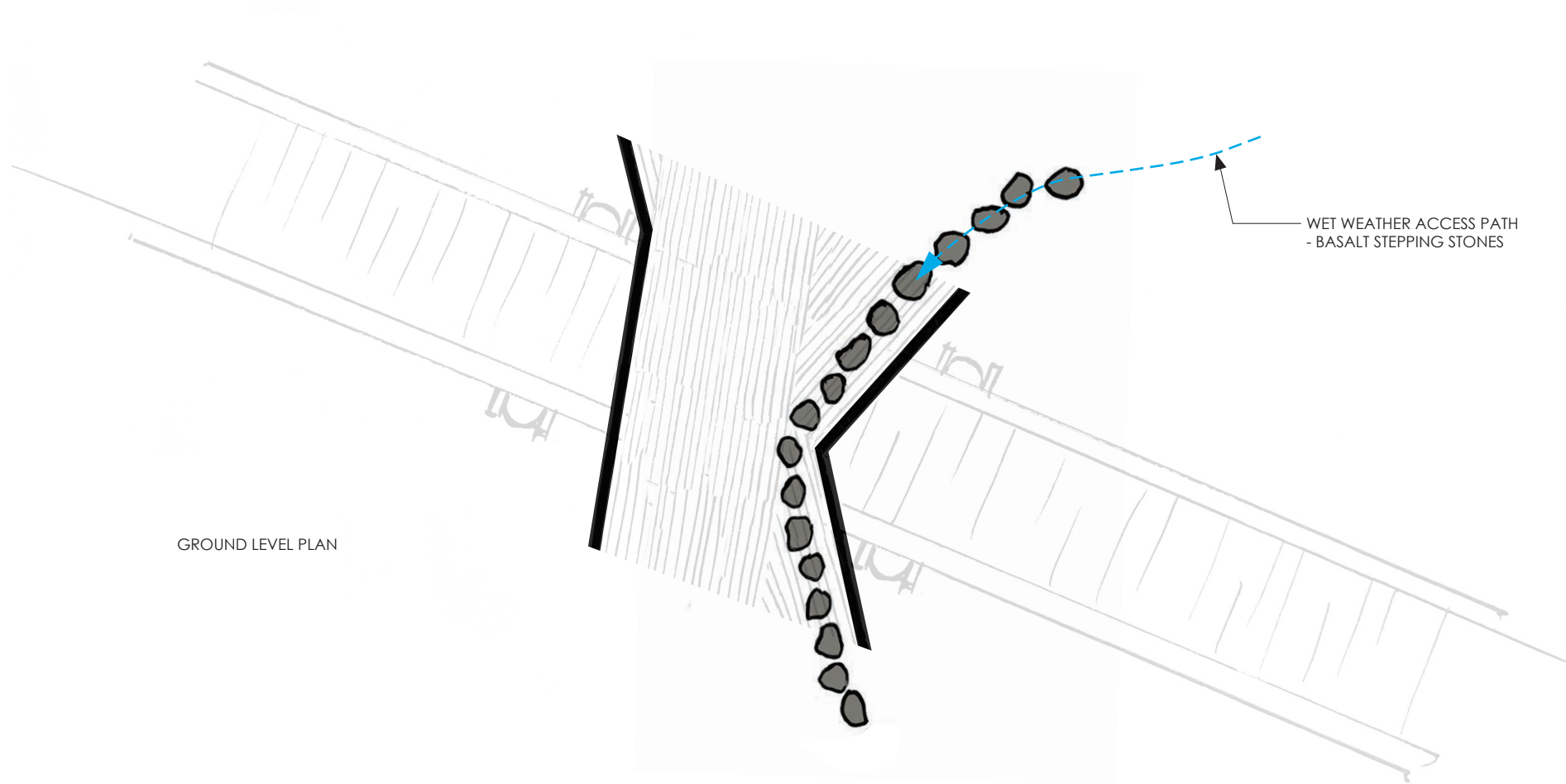

GROUND LEVEL PLAN



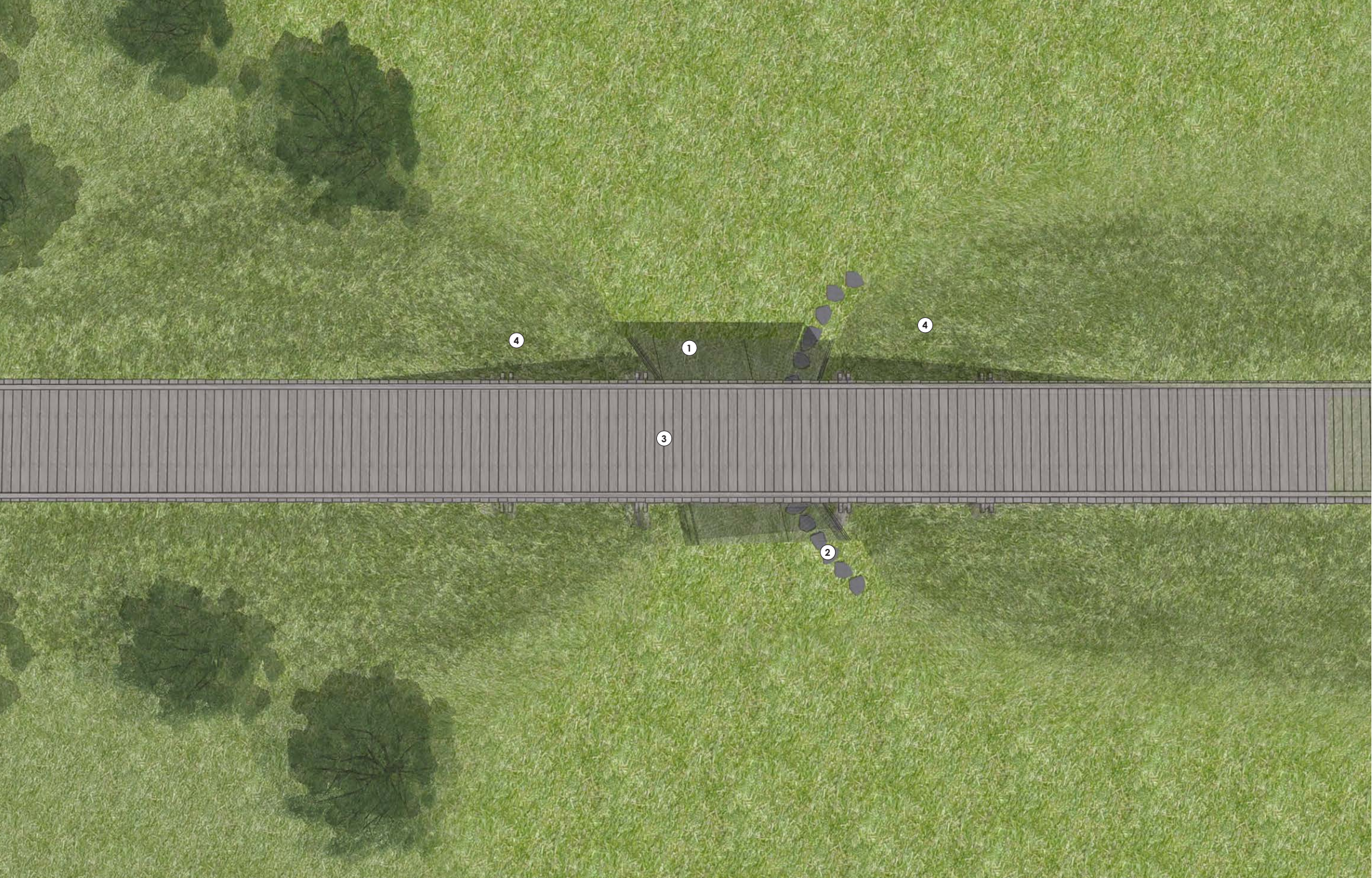

PLAN VIEW

- ① GALV. 'GRIDFORGE' STEEL MESH PORTAL FOR PEDESTRIAN SAFETY
- ② ELEVATED BASALT STEPPING STONES FOR WET WEATHER PATHWAY
- ③ EXISTING RAIL BRIDGE
- ④ EMBANKMENT CLEARED OF MIRROR BUSH AND OTHER WEEDY SCRUB, AND PLANTED OUT WITH SUITABLE LOW INDIGENOUS PLANTING FOLLOWING COMPLETION OF BRIDGE PORTAL WORKS

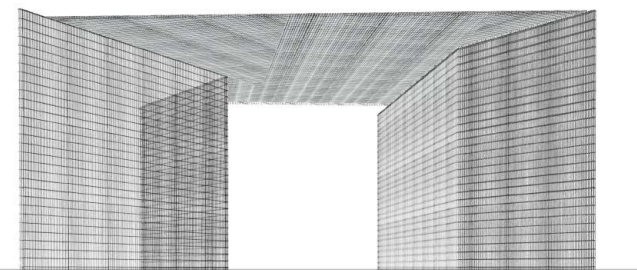
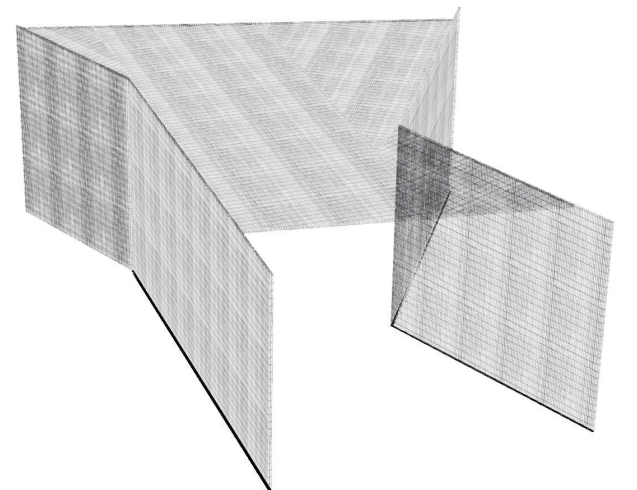
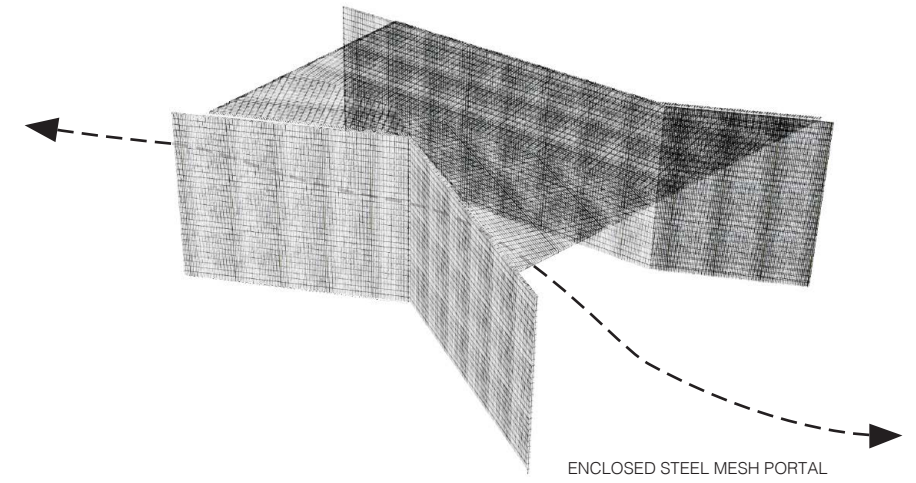

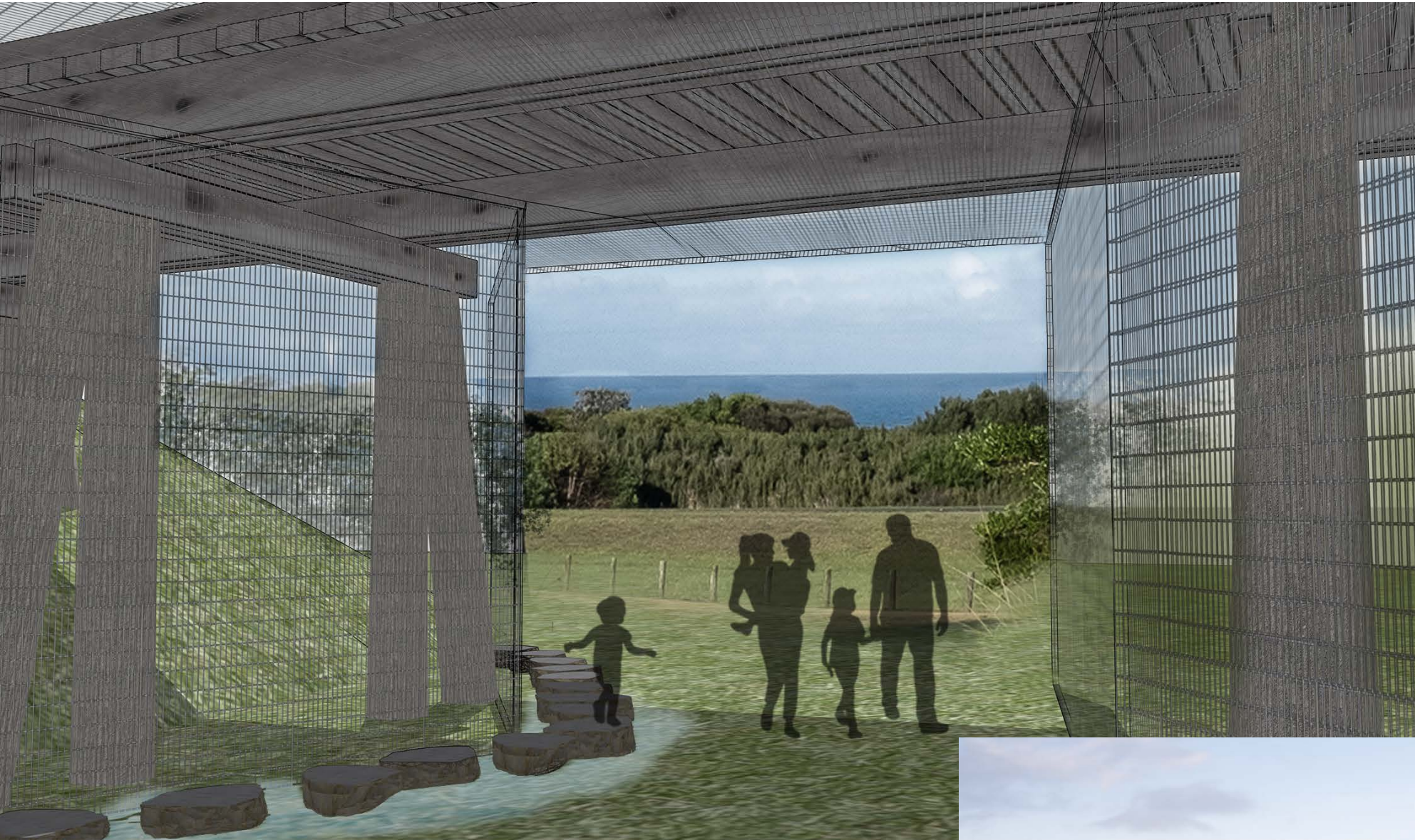

- ① GALV. 'GRIDFORGE' STEEL MESH PORTAL FOR PEDESTRIAN SAFETY
- ② ELEVATED BASALT STEPPING STONES FOR WET WEATHER PATHWAY
- ③ EXISTING RAIL BRIDGE
- ④ EMBANKMENT CLEARED OF MIRROR BUSH AND OTHER WEEDY SCRUB, AND PLANTED OUT WITH SUITABLE LOW INDIGENOUS PLANTING FOLLOWING COMPLETION OF BRIDGE PORTAL WORKS

VIEW - FROM NORTH-EAST

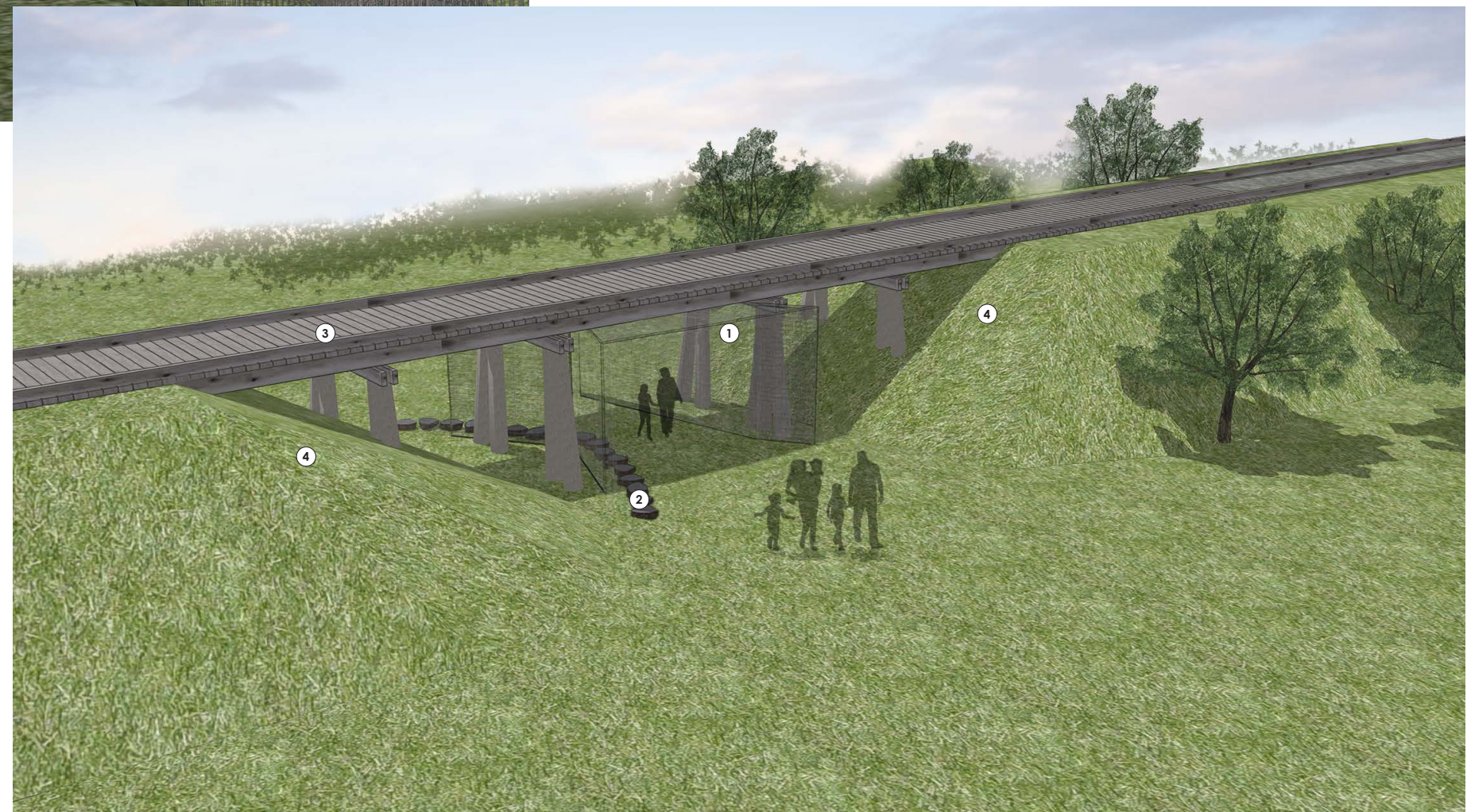



VIEW - FROM NORTH

VIEW - FROM NORTH-EAST

